

ZONING

Section 190-18

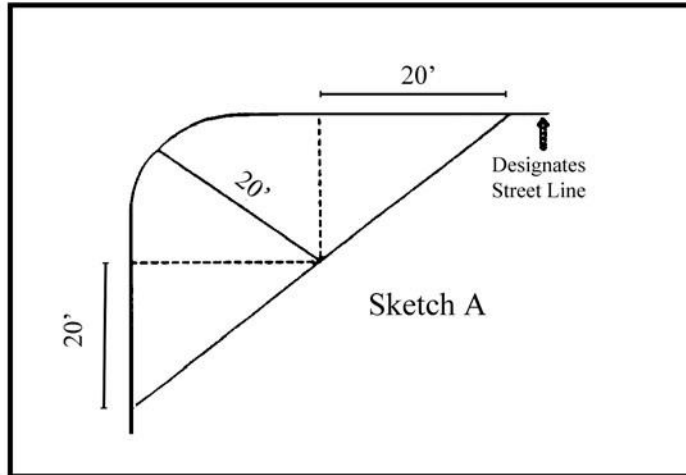

- E. A fence or freestanding wall no more than four (4) feet high is permitted on the property line within the required front setback. A fence or wall no more than eight (8) feet high is permitted on any property line behind the front setback. Any fence or wall over that height is permitted parallel to the side and rear lot lines, provided that it is set back from the property line a distance of at least two-thirds (2/3) its height. Finished faces must face outward.
- H. Fences, walls, posts, ornaments, furniture, pavement, curbing, planters, trellises, approved signs, landscaping and other customary yard accessories are permitted within all setbacks, subject to height and visibility limitations.

§ 190-19. Measurement of setbacks.

- A. All required front setbacks shall be measured from the lot line or the designated street line, whichever is the greatest distance from the center line of the travelway abutting the lot. Where lots are situated on other than a public street or where the line is not a designated street line, the lot line is measured parallel to the center line at a distance from the center line of twenty-five (25) feet along

§190-20. Corner lot and through lot setbacks.

- A. A front setback is required on a corner lot for each street line. The plat and/or plans shall show which of the remaining setbacks are to be side and rear respectively.
- B. On a through lot, front setbacks are required on both streets. Each front setback shall be measured from the street line as defined in this chapter.

A front setback is required on a corner lot for each street line. The plat and/or plans shall show which of the remaining setbacks are to be side and rear respectively.